

- NOTES:
- DO NOT SCALE. USE FIGURED DIMENSIONS ONLY.
 - THIS DRAWING IS TO BE READ IN CONJUNCTION WITH ALL OTHER RELEVANT ARCHITECTURAL AND ENGINEERING DRAWINGS.

LEGEND	
	SITE BOUNDARY PHASE 2
	SITE BOUNDARY PHASE 1 APPROVED DEVELOPMENT ASP-REF.PL17.241988 UNDER CONSTRUCTION
	PROPOSED 150mm KERB
	PROPOSED 125mm KERB
	PROPOSED 75mm KERB
	PROPOSED 25mm KERB
	PROPOSED CROSS OVER 75/25mm KERB
	PROPOSED CHANEL KERB
	PROPOSED FLUSH KERB
	PROPOSED BACK OF FOOTPATH
	CENTER LINE WITH CHANGE
	FINISHED ROAD LEVELS
	ROAD GRADIENT
	HOMEZONE/SHARED SURFACE
	ROAD
	FOOTPATH
	SHARED SURFACE (FOOTPATH/CYCLEPATH)

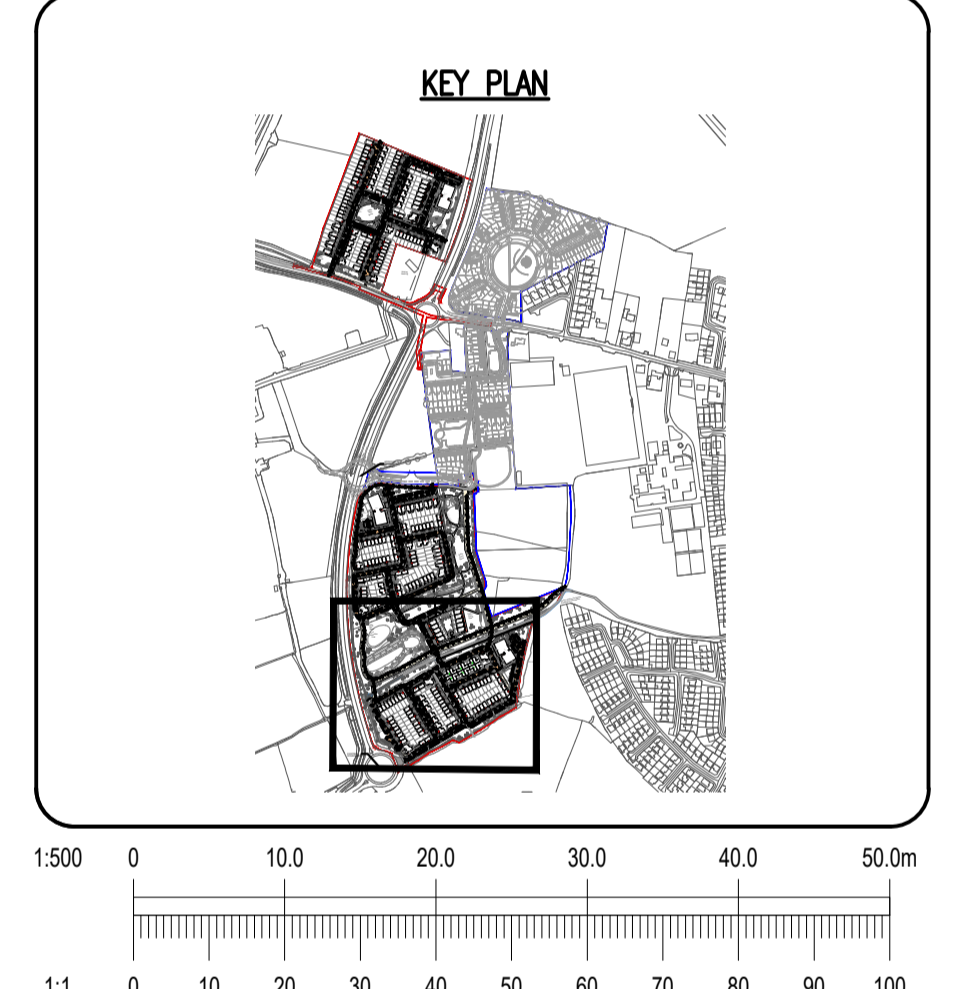

Ordnance Survey Ireland Licence No. EN 0006020 ©Ordnance Survey Ireland/Government of Ireland.			
A	02/10/20	SHD APPLICATION ISSUE	MK IS
~	18/03/20	SHD PRE-APPLICATION ISSUE	MK IS
REV.	DATE	AMENDMENT	DRN APPD

STATUS **FOR SHD APPLICATION**

Waterman Moylan
Engineering Consultants
BLOCK 5, EASTPOINT BUSINESS PARK, ALFIE BYRNE ROAD,
DUBLIN D03 H3F4 IRELAND. Tel: (01) 664 8900
Email: info@waterman-moylan.ie www.waterman-moylan.ie

CLIENT **CASTELTHORN CONSTRUCTION ULC**
ARCHITECT **O'MAHONY PIKE ARCHITECTS**
PROJECT **PROPOSED PHASE 2 RESIDENTIAL DEVELOPMENT AT DUNSHAUGHLIN, CO. MEATH**

TITLE **ROAD LAYOUT SHEET 2 OF 3**

DRAWN MK	DESIGNED KV	APPROVED IS	DATE MARCH 2020
SCALE 1:500 @ A1	JOB NO. 12-081A	DRG. NO. P112	REVISION A

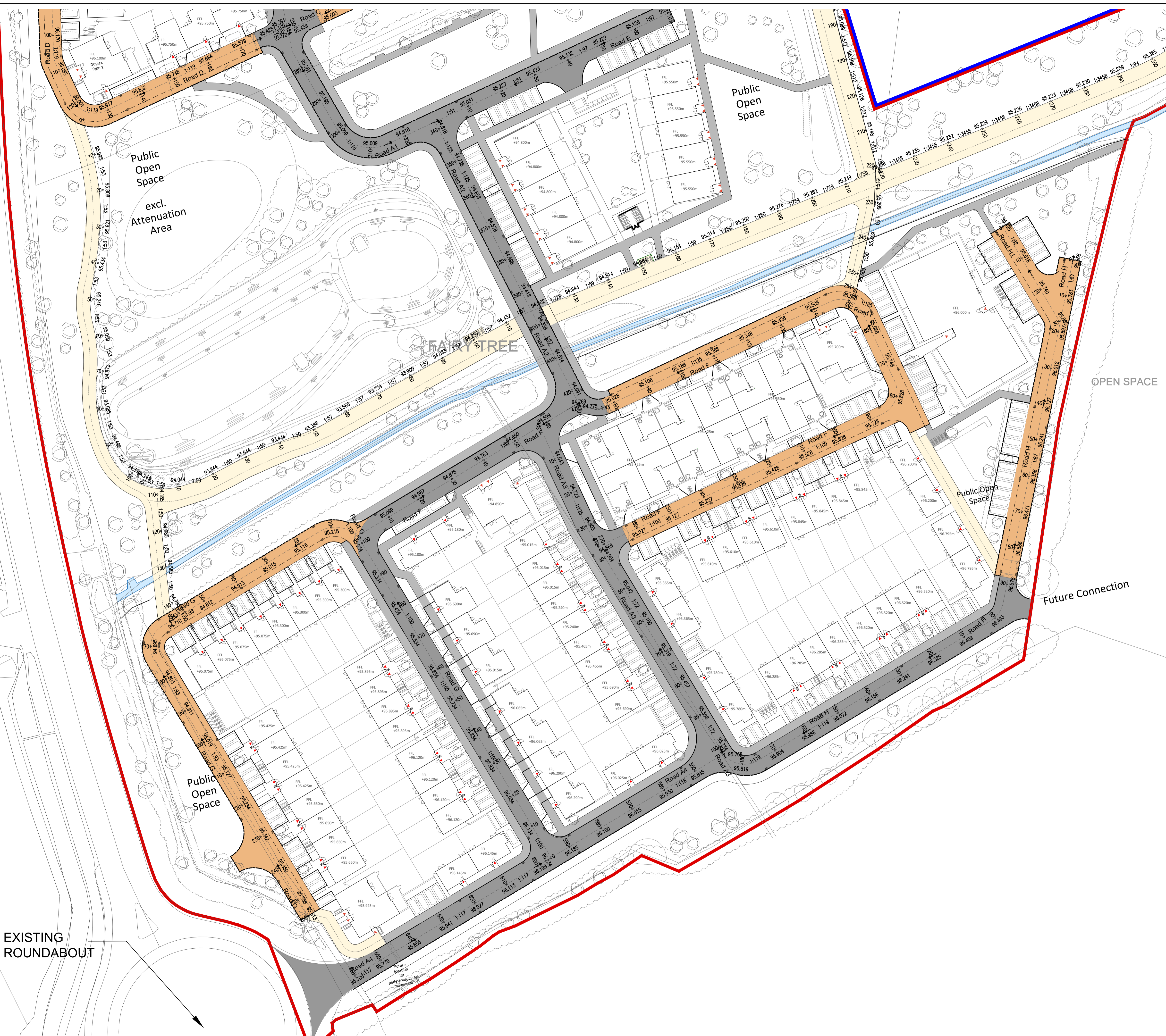

EXISTING ROUNDABOUT

© 2017. This drawing is copyright. No part of this document may be reproduced or transmitted in any form or stored in any retrieval system of any nature without the written permission of the consulting engineer in copyright. Under no circumstances shall the engineer be held liable for any errors or omissions in this drawing.